

# Plain Language Summary



CLAY COUNTY  
**MEDICAL  
CENTER**



## Financial Assistance Summary

---

Clay County Medical Center offers financial assistance to qualified patients.

These patients may receive services provided at no charge or at a reduced charge to patients who do not have, or cannot obtain, adequate financial resources to pay for their care.

## Requirements and Eligibility

---

Patients completing the financial assistance process must agree to a financial screening. We have partnered with The Midland Group to have a Patient Financial Advocate on site to assist with the screening and application process.

Those whose household income falls within 200% of the Federal Poverty Guidelines are eligible for a discount of services at CCMC.

Patients who complete and submit a Financial Assistance Application (FAA) must include additional supporting documentation.

Our Patient Financial Advocate can provide the FAA and other financial assistance information in office 128, near the main entrance of the hospital. These materials are also available at the registration desks during business hours, as well as online at [www.ccmcks.org/financialassistance.php](http://www.ccmcks.org/financialassistance.php). Patients may request a free copy of the FAA to be mailed.

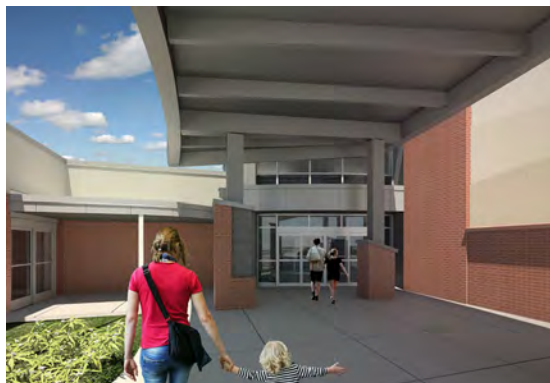

The FAA, the Financial Assistance Policy (FAP), and the Plain Language Summary (PLS) are available in English and Spanish.

No private-pay, FAP-eligible individual will be charged more for emergency or other medically necessary care than the amounts generally billed (AGB).

## Definition

---

*Amounts generally billed (AGB)* means the amounts generally billed for emergency or other medically necessary care to individuals who have insurance covering such care.

## CONTACT US

### Patient Financial Advocate:

(P) 785-630-2479

(F) 785-630-5262

### Patient Account Rep:

(P) 785-630-2471

(F) 785-630-2762

Clay County Medical Center

617 Liberty St

Clay Center, KS 67432

(785) 632-2144